



IN  
DUS  
TRY





## C Y L I N D E R S

### SINGLE ACTING CYLINDERS

#### SPRING RETURN

SS:	GENERAL USE	Page 06
SSR:	REDUCED HEIGHT	Page 08
SSE:	EXTRA-FLAT	Page 09
SSH:	HOLLOW PISTON	Page 10
SSET:	TELESCOPIC EXTRA-FLAT	Page 11

## T O O L S

PUMPS	Page 20
FITTINGS, PORTS END PRESSURE GAUGES	Page 28
HOSES AND QUICK COUPLINGS	Page 29

## Safety, use, and maintenance

### Information

Carefully read the safety, use, and maintenance instructions that come with each piece of hydraulic equipment. Failure to follow these essential guidelines may result in damage to the user, the hydraulic equipment, or the item being lifted.

Always use a cylinder with a lifting force and hydraulic stroke that are 25% greater.

Once the equipment has been used, clean it, fully retract the cylinder piston, and store it away from harsh environments.

Important: Excess oil can prevent the pump from working.

Very important: Never use brake fluid.

All our items come with a repair kit.

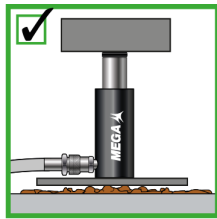

Provide a firm, level support surface for the cylinder. Use a cylinder base to increase stability.

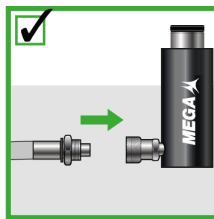
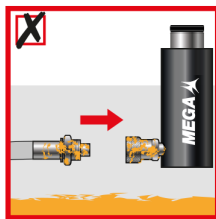

Clean both halves of the coupling before connecting. Use dust caps when the coupling halves are not connected.

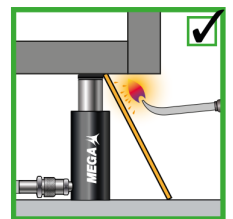
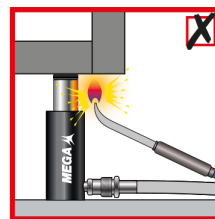

Keep hydraulic equipment away from open flames and temperatures above 65°C (150°F).

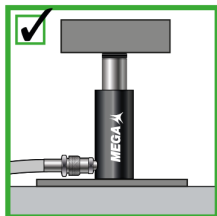

Never allow cylinders to be lifted off the ground by their couplings.

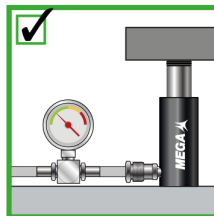

Do not tamper with factory settings on safety valves. Always use a pressure gauge to monitor system pressure.



Do not use the cylinder without a saddle. This will cause the cylinder to deform. Saddles distribute the load evenly over the rod.

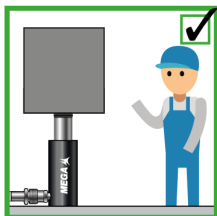

Never place any part of your body under the load. Make sure the load is properly supported before standing under it.

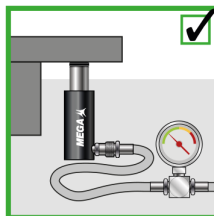
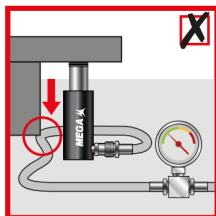

Keep hoses away from the area under the load.

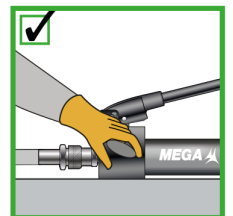
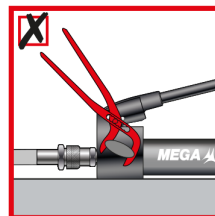

Close the discharge valve by hand. Using force will damage the valve.



Never place any part of your body under the load. Make sure the load is well supported before standing under it.

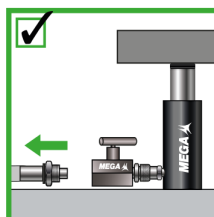
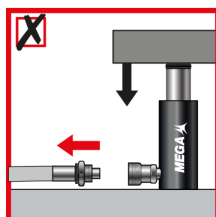

Disconnect the cylinder only when it is fully retracted or use isolation valves to maintain cylinder pressure.

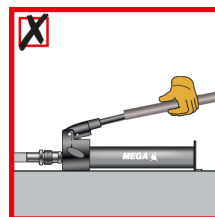

Do not use extensions with the levers. When used correctly, hand pumps operate easily.

## Basic settings

- 1** Cylinder  
Lifts the load.
- 2** Pump  
Injects the hydraulic fluid.
- 3** Hose  
Conducts the oil.
- 4** A-5507-M Male fitting  
Quick coupling.
- 5** A-5507-M Female fitting  
Quick coupling.
- 6** Pressure gauge  
Indicates the pressure in the circuit.
- 7** Pressure gauge adapter  
For installing the pressure gauge.
- 8** A-5510 Safety valve  
Automatically retains the load during lifting.
- 9** A-5509 Shut-off valve  
Shuts off the fluid flow. Also locks the load on the cylinder.
- 10** A-5538 Descending valve  
Automatically produces resistance to fluid circulation to prevent sudden return of the load.
- 11** Distributor  
Allows fluid distribution
- 12** A-5511 Fitting  
Connection between different elements

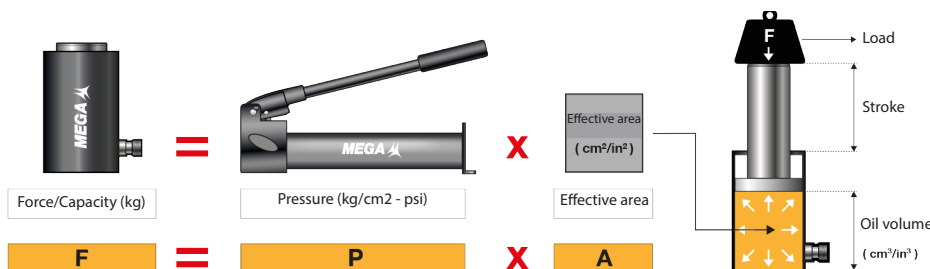
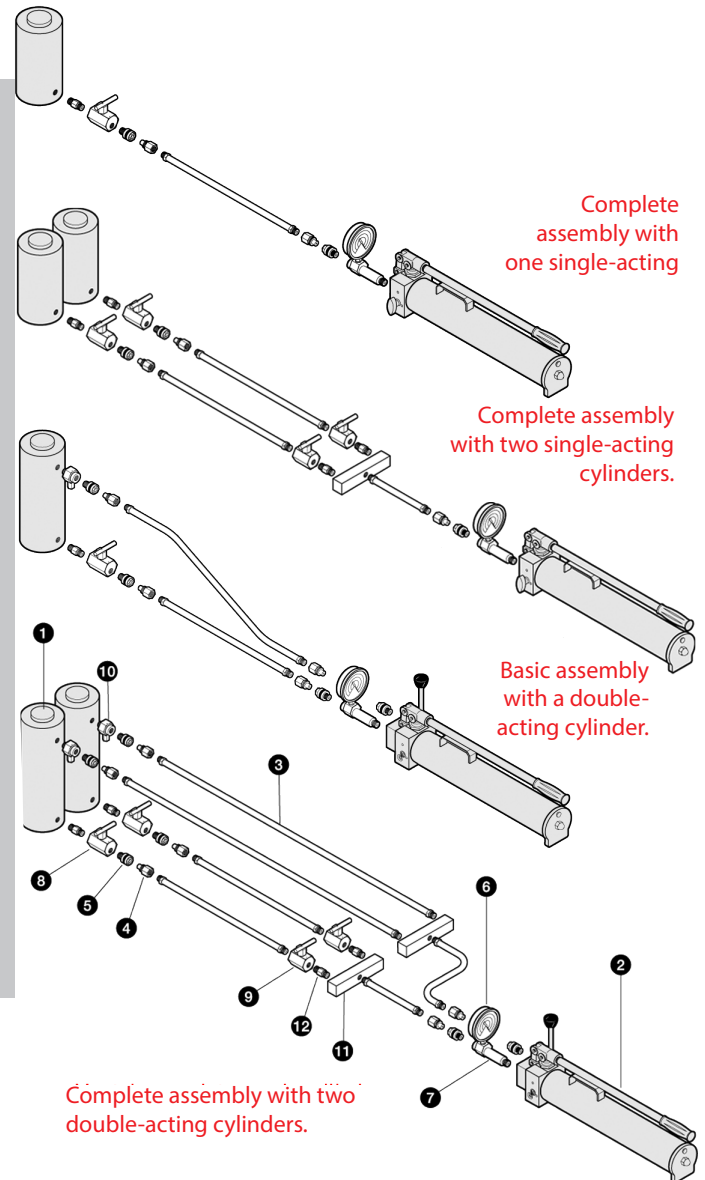

The equipment consists of three main components:

- a) the power source: the pump
- b) the tool: cylinder/cylinders
- c) flexible hose

This combination of hydraulic components allows a wide variety of operations to be performed remotely, such as lifting loads, pushing or pulling them, and clamping or bending different elements.

A hydraulic system can be designed to perform specific tasks, always based on the same basic hydraulic assembly of pump and cylinder.

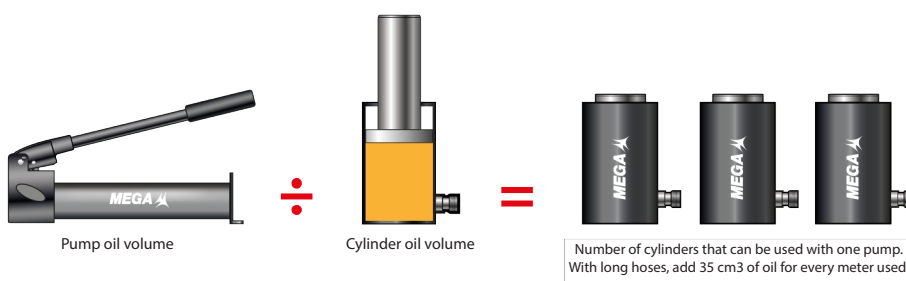



## SS SERIES

### SINGLE ACTING CYLINDERS - SPRING RETURN

Spring return.

Scratch and corrosion resistant chrome-plated piston.

Bronze guide to prevent side loads.

They have a removable head, press-fit or screw-fit, and a high-flow female quick connector, ref. A-5507-H, with dust cap.

With holes and threaded parts that facilitate the attachment of accessories and special tools.

Supplied with external thread protector.

Specially designed for heavy-duty use.

Working pressure: 700 kg / cm<sup>2</sup> / 10.000 psi

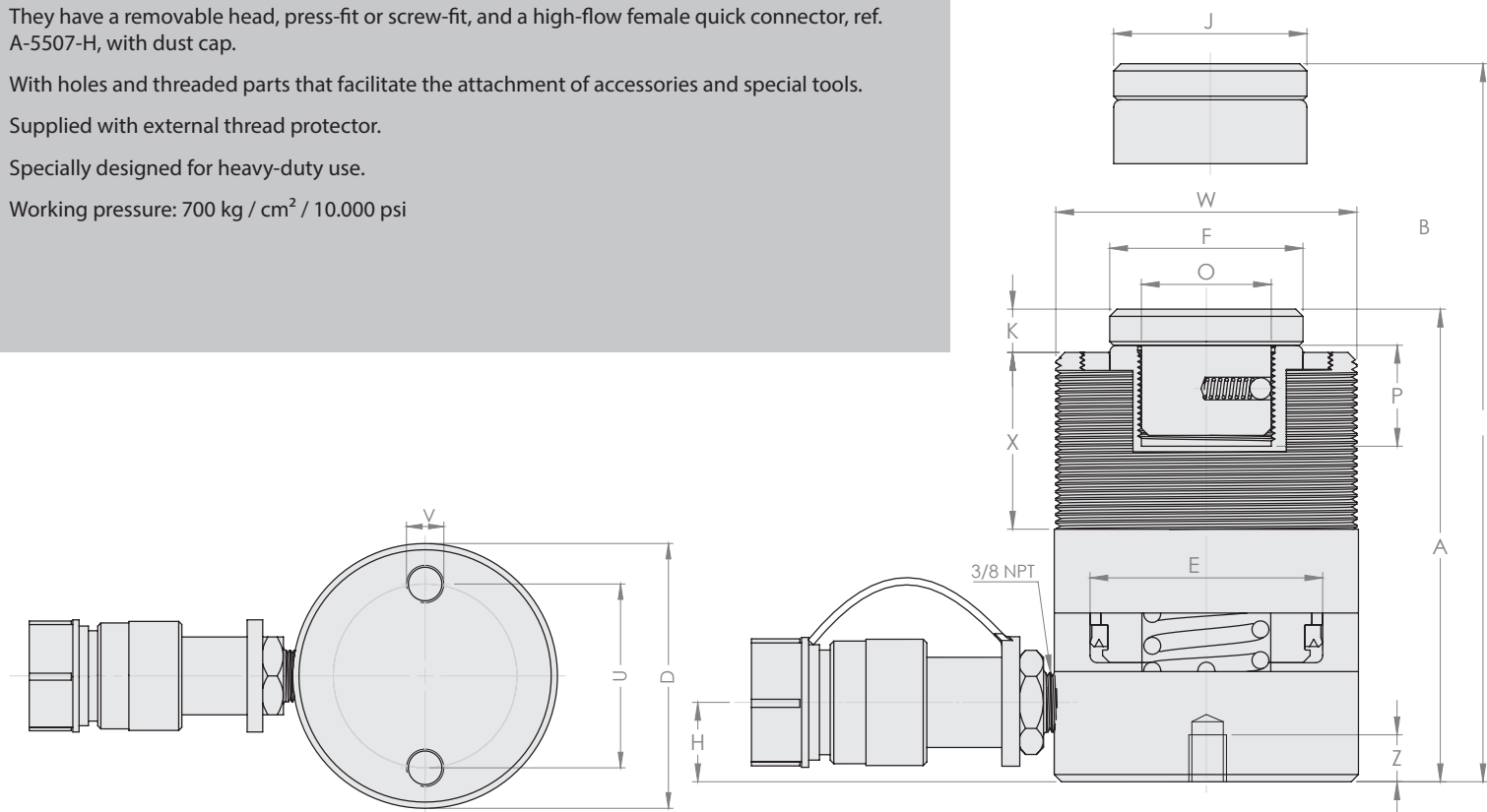

CODE	TONNAGE (T)	STROKE (mm)	OIL CAP. (cm <sup>3</sup> )	A MIN. HEIGHT (mm)	B MAX. HEIGHT (mm)	D (Ø mm)	E (Ø mm)	F (Ø mm)	H (mm)
SS576	5	76	54	165	241	38	30	25.4	19
SS5127	5	127	90	216	343	38	30	25.4	19
SS1025	10	25.4	36.5	90	115.4	57	42.8	38	19
SS1051	10	51	73	121	172	57	42.8	38	19
SS10101	10	101	145	171	272	57	42.8	38	19
SS10152	10	152.5	242	247	399.5	57	45	38	19
SS1526	15	26.5	63	124	150.5	73	55	40	19
SS1552	15	52.5	125	149.6	202.1	73	55	40	19
SS15102	15	102.5	243	200	302.5	73	55	40	19
SS15153	15	153	363	271.6	424.6	73	55	40	25
SS2525	25	25.5	98	139.5	165	88	70	55	25
SS2551	25	51	196	165	216	88	70	55	25
SS25102	25	102	392	216	318	88	70	55	25
SS25158	25	158.5	610	273	431.5	88	70	55	25
SS3060	30	60	265	165	225	100	70	50	30
SS5051	50	51	361	177	228	127	95	80	33
SS50101	50	101.5	719	229	330.5	127	95	80	33
SS50157	50	157.5	1116	283	440.5	127	95	80	33



SS1051



SS576



SS10101



SS15153



SS10152

J (mm)	K (mm)	O (Ø UN)	P (mm)	U (mm)	V (Ø UNC)	Z (mm)	W (Ø UN)	X (mm)	WEIGHT (kg)
25	6	¾"-16	14	25	¼"-20	14	1½"-16	28	1.5
25	6	¾"-16	14	25	¼"-20	14	1½"-16	28	1.9
-	-	#10-24UN	6.5	39	5/16"-18	13	2¼"-14	30	1.8
40	6	1"-8	19	39	5/16"-18	13	2¼"-14	30	2.3
40	6	1"-8	19	39	5/16"-18	13	2¼"-14	30	3.3
40	6	1"-8	19	39	5/16"-18	13	2¼"-14	30	4.4
38	9.6	1"-8	25.4	47.7	3/8"-16	13	2¾"-16	30	3.3
38	9.6	1"-8	25.4	47.7	3/8"-16	13	2¾"-16	30	4.1
38	9.6	1"-8	25.4	47.7	3/8"-16	13	2¾"-16	30	5
38	9.6	1"-8	25.4	47.7	3/8"-16	13	2¾"-16	30	6.8
50	10.5	1½"-16	25.4	58	½"-13	19	3⅝"-12	50	5.9
50	10.5	1½"-16	25.4	58	½"-13	19	3⅝"-12	50	6.4
50	10.5	1½"-16	25.4	58	½"-13	19	3⅝"-12	50	8.2
50	10.5	1½"-16	25.4	58	½"-13	19	3⅝"-12	50	10
50	10.5	1½"-16	25.4	66	½"-13	19	3⅞"-12	48	7.9
70	3	-	-	95	½"-13	19	5"-12	55	15
70	3	-	-	95	½"-13	19	5"-12	55	19.1
70	3	-	-	95	½"-13	19	5"-12	55	23.1

## SSR SERIES

### SINGLE-ACTING CYLINDERS REDUCED HEIGHT SPRING RETURN

Spring return.

Scratch- and corrosion-resistant chrome-plated piston.

Bronze guide to prevent side loads.

They have a removable head, press-fit or screw-fit, and a high-flow female quick connector, ref. A-5507-H, with dust cap.

With holes and threaded parts that facilitate the attachment of accessories and special tools.

Specially designed for heavy-duty use.

Working pressure: 700 kg / cm<sup>2</sup> / 10.000 psi



SSR10058



SSR1038



SSR2045



SSR3062



SSR5060

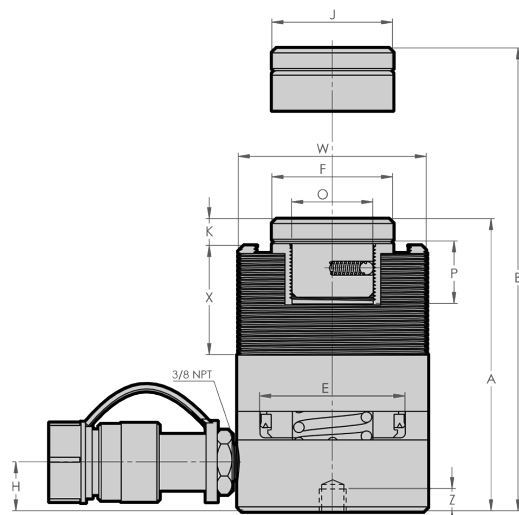
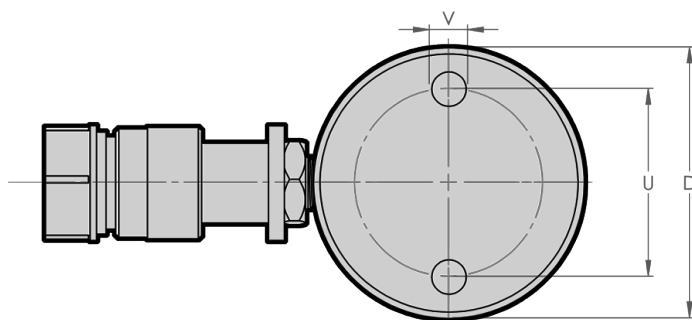

REF.	TONNAGE (T)	STROKE (mm)	OIL CAP. (cm <sup>3</sup> )	A MIN HEIG. (mm)	B MAX HEIG. (mm)	D (mm)	E Ø (mm)	F Ø (mm)	H (mm)	K (mm)	O Ø (mm)	P Ø (mm)	U (mm)	WEIGHT (kg)
SSR1038	10	38	55.0	88	126	78	42.8	38	17.5	5	M4	8	26	4.1
SSR2045	20	45	127	98	143	97	60	50.8	17.5	3	M5	9	39	5
SSR3062	30	62	274	117	179	107	75	63.5	19	3	M5	8	39	6.8
SSR5060	50	60.5	429	127	187.5	127	95	70	19	2	M5	8	39	10.9





SSE1012

## SSE SERIES

### SINGLE-ACTING CYLINDERS SPRING RETURN - EXTRA-FLAT

Spring return.

Scratch- and corrosion-resistant chrome-plated piston.

They have a high-flow female quick-connect coupling, ref. A-5507-H, with dust cap.

With holes and threaded parts that facilitate the attachment of accessories and special tools.

Specially designed for heavy-duty use in hard-to-reach areas.

Working pressure: 700 kg / cm<sup>2</sup> / 10.000 psi



SSE56



SSE2012



SSE3013

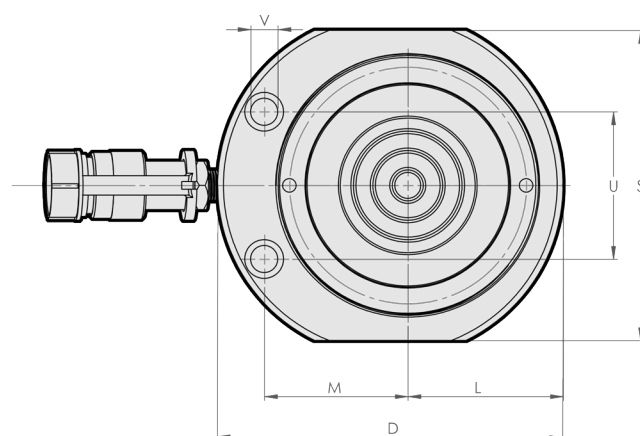
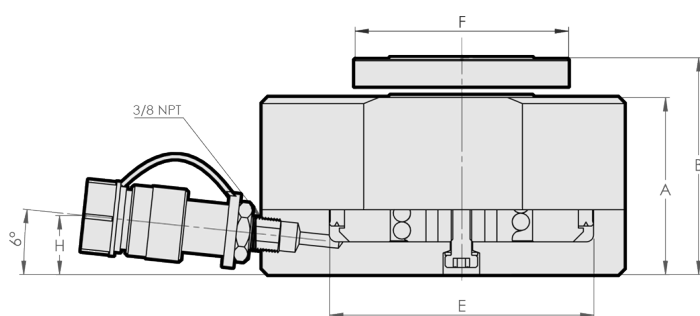

REF.	TON. (T)	STROKE (mm)	OIL CAP. (cm <sup>3</sup> )	A MIN HEI. (mm)	B MAX HEI. (mm)	C (mm)	D (mm)	E (mm)	F Ø (mm)	H (mm)	K (mm)	V Ø (mm)	G Ø (mm)	L (mm)	M (mm)	WEI. (kg)
SSE56	5	6	4.5	33	39	28.5	58.5 x 44	31	25.4	16	1	5.3	9.5	22	22	0.7
SSE1012	10	12	18	42	54	36.5	82.5 x 60	44	38	19	1	7.5	11	30	34	1.6
SSE2012	20	12	34	51	63	49.3	100 x 78	60	50.8	19	1	10	15	39	39	2.6
SSE3013	30	13	54	58	71	52.3	117.5 x 95	73	63.5	19	2	10	16	47.5	47.5	4.5
SSE5016	50	16	113	66	82	66.5	145 x 115	95	70	19	2	11	19	57.5	58	6.8

## SSH Series

### SINGLE-ACTING CYLINDERS SPRING RETURN - HOLLOW PISTON

Spring return.

Scratch- and corrosion-resistant chrome-plated hollow piston.

Bronze guide to prevent side loads.

They have a removable, screw-on head and a high-flow female quick-connect fitting, ref. A-5507-H, with dust cap.

With holes and threaded parts that facilitate the attachment of accessories and special tools.

For push and pull applications: Tensioning cables and bolts, removing bushings and bearings.

Smooth hollow head as standard. Optional threaded heads.

Working pressure: 700 kg / cm<sup>2</sup> / 10.000 psi



SSH2050



SSH3064

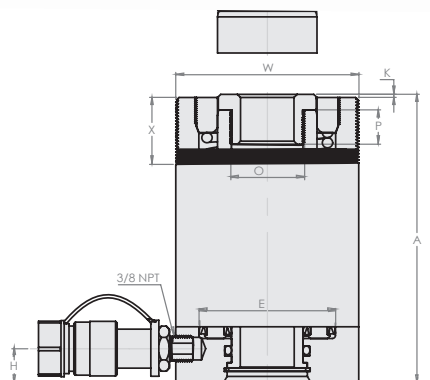
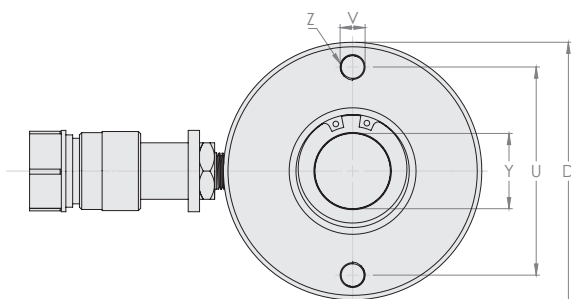

REF.	TON. (T)	STROKE (mm)	OIL CAP. (cm <sup>3</sup> )	A MIN HEL. (mm)	B MAX HEL. (mm)	D Ø (mm)	E Ø (mm)	F Ø (mm)	H (mm)	O	P (mm)	V (mm)	Z (mm)	W		Y Ø (mm)	WEI. (kg)
SSH2050	20	50	145	165	215	98	70	50.5	21.5	M37x1.5	20	3/8-16UNC	15	3 7/8"-12UN	38	27	9
SSH3064	30	64	270	197	261	114	86	62	29	M46x1.5	22	3/8-16UNC	22	4 1/2"-12UN	42	34	12

## SSET SERIES

### SINGLE-ACTING CYLINDERS SPRING RETURN - TELESCOPIC EXTRA-FLAT



Spring return.

Scratch- and corrosion-resistant chrome-plated piston.

They have a high-flow female quick connector, ref. A-5507-H, with dust cap.

With holes and threaded parts that facilitate the attachment of accessories and special tools.

Specially designed for heavy-duty use in areas that are difficult to access and at high elevations.

Working pressure: 700 kg / cm<sup>2</sup> / 10.000 psi

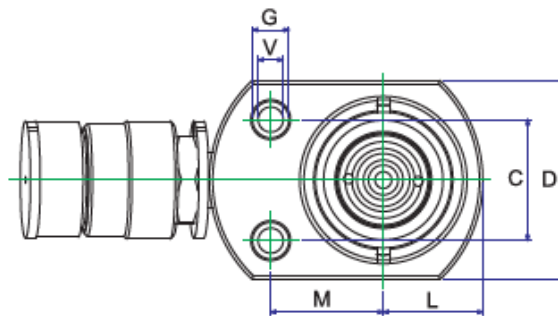
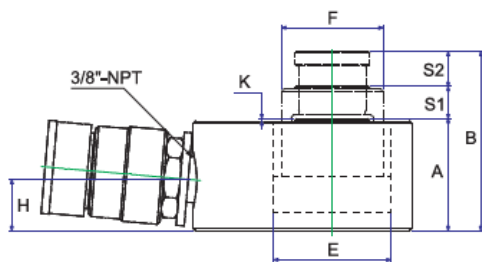

REF.	TONNAGE (T)		STROKE (mm)		OIL CAP. (cm <sup>3</sup> )
	S1	S2	S1	S2	
SSET10	10	5	12	13	29

REF.	A MIN HEIGHT (mm)	B MAX HEIGHT (mm)	C (mm)	D (mm)	E Ø (mm)	F Ø (mm)	H (mm)	K (mm)	V Ø (mm)	G Ø (mm)	L Ø (mm)	M Ø (mm)	WEI. (kg)
SSET10	42	67	36.5	82.5x60	44	38	19	1	7.5	11	30	34	1.6
SSET20	51	76	49.3	100x78	60	50.8	19	1	10	15	39	39	2.6



## BM Series PUMPS

### SINGLE-ACTING MANUAL HYDRAULIC PUMPS

#### ONE SPEED: BM04 - BM061 - BM141

Single-speed manual pumps, suitable for fixed or portable use, in horizontal or vertical position. In the latter position, the head must be positioned downwards. Their low weight and small size make them particularly useful for jobs requiring quick maneuvering.

They are equipped with a pressure relief valve, calibrated to the maximum working pressure.



BM-061



BM-141

#### TWO SPEEDS: BM032 - BM062 - BM222 - BM352

Single-acting, two-speed manual pumps. The automatic two-stage system allows for rapid approach to the load.

They are equipped with a pressure relief valve, calibrated to the maximum working pressure.



BM-032



BM-062



BM-222

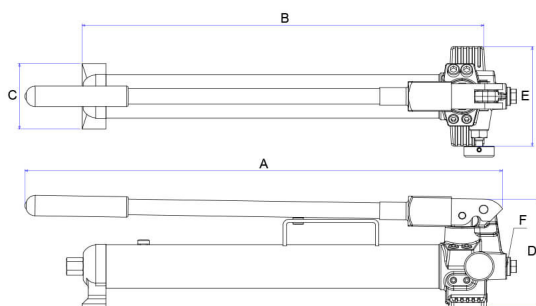

REF.	WORK PRESSURE (Kg/cm2)		OIL CAP. (cm³)	OIL VOLUME PER STROKE (cm3 )		A (mm)	B (mm)	C (mm)	D (mm)	E (mm)	F	WEI. (kg)
	STAGE1	STAGE2		STAGE1	STAGE2							
				cm³	cm³							
BM032	20	700	280	7	1	343	310	66	127	142	3/8 NPT	5.5
BM04	700	-	400	2.5	-	400	460	97	137	127	3/8 NPT	4.3
BM061	700	-	640	3.2	-	632	526	90	148	137	3/8 NPT	7.6
BM062	20	700	640	13	2.8	633	528	90	148	137	3/8 NPT	8
BM141	700	-	1400	3.2	-	635	526	106	174	137	3/8 NPT	10.9
BM222	20	700	2200	13	2.8	713	632	106	200	142	3/8 NPT	12
BM352	28	700	3500	30	3	626	586	146	80.5	196	3/8 NPT	16.5

## BMD Series PUMPS

### DOUBLE-ACTING MANUAL HYDRAULIC PUMPS

Equipped with a 4-way, 3-position valve for use with double-acting cylinders.

The automatic two-stage system allows for rapid approach to the load.

Internal safety valve to prevent overpressure.



BMD-5

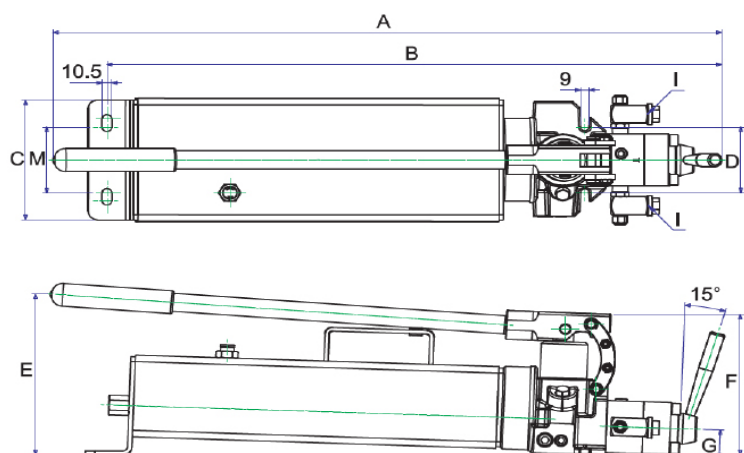

REF.	Nominal pressure (bar)		OIL CAP. (cm <sup>3</sup> )	OIL VOLUME PER STROKE (cm <sup>3</sup> )		A (mm)	B (mm)	C (mm)	D (mm)	E (mm)	F (mm)	G (mm)	I (mm)	M (mm)	WEI. (kg)
	STAGE 1	STAGE 2		STAGE1	STAGE2										
BMD5	28	700	4450	30	3	741	680	146	80.5	196	171.5	35	3/8"NPT	80.5	22.5

# NS Series PUMPS

## OIL-PNEUMATIC PUMPS

Single-acting, single-speed pumps.

The pedal acts as a control valve, controlling forward, hold, and discharge. In hold mode, the pump maintains the outlet pressure.

With safety valve calibrated to maximum working precision.

Air pressure: 2.8-10 bar.

Noise level: 75 dBA



NS2

REF.	MAX PRESSURE (Kg/cm²)	USEFUL OIL (cm³)	OIL FLOW (l/min)		CONNECTION		PNEUMATIC RANK (bar)	AVERAGE AIR CONSUMPTION (l/min)	NOISE LEVEL (dBA)	WEIGHT (kg)
			UNLOADED	LOADED	OIL	AIR				
NS2	700	2100	1.1	0.15	3/8"NPT	G1/4"	2.8 - 10	50/440	75	6.5



## ND5 PUMPS

Electric pumps. Double-acting.

Two-stage, double-acting pumps equipped with a 4-way, 3-position manual control valve.

The distribution lever allows oil to be sent through one of the two conduits. For double-acting cylinders.

With overpressure valve, calibrated to maximum working pressure. In continuous operation, the pressure must not exceed 560 kg/cm<sup>2</sup>/8.000 psi.

Oil connection: 3/8 NPT.

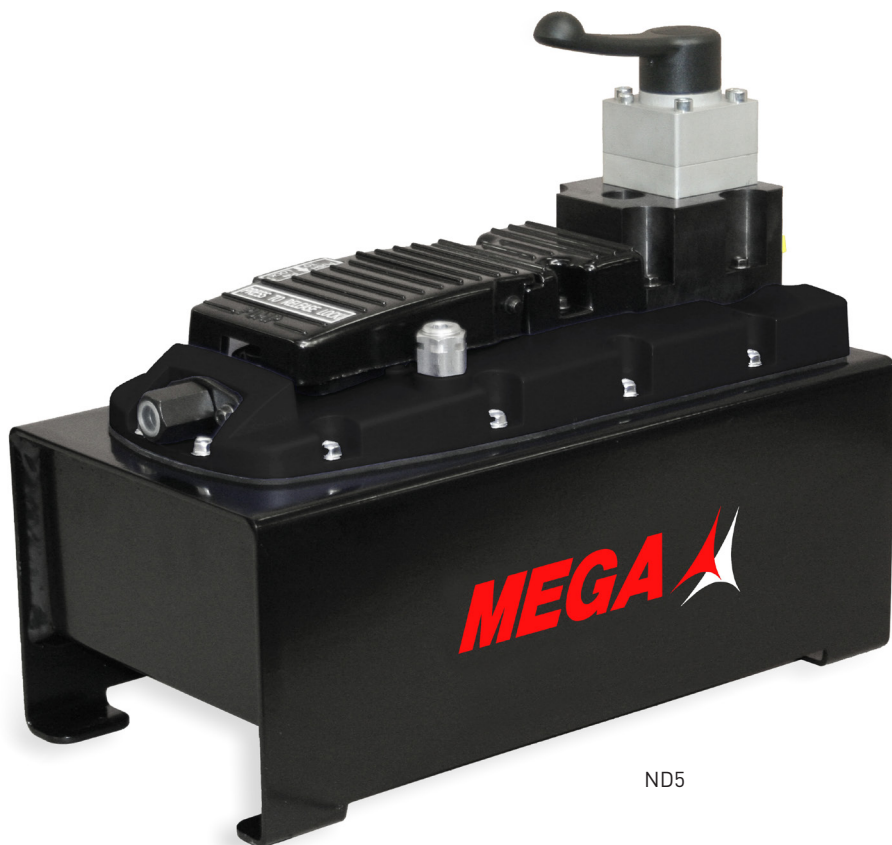

ND5

REF.	MAX PRESSURE (Kg/cm <sup>2</sup> )	USEFUL OIL (cm <sup>3</sup> )	OIL FLOW (l/min)		CONNECTION		PNEUMATIC RANK (bar)	AVERAGE AIR CONSUMPTION (l/min)	NOISE LEVEL (dBA)	WEIGHT (kg)
			UNLOADED	LOADED	OIL	AIR				
ND5	700	4600	1.1	0.15	3/8"NPT	G1/4"	2.8 - 10	50/440	75	15.2

# BDD Series PUMPS

## DOUBLE-ACTING ELECTRIC PUMP

- Manual directional control valves.
- Easily modifiable manual valve from double to single acting.
- Internal safety valve calibrated to 700 bar to prevent overpressure.
- External pressure relief valve adjustable by the user.
- For use with single or double acting cylinders for production or heavy lifting applications.

NOTE: Pressure gauge not included.

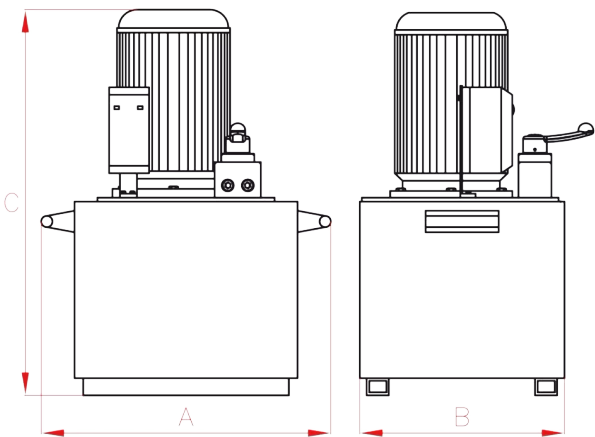

BDD-5

REF.	MAX PRESSURE (Kg/cm²)	TANK CAPACITY (litros)	OUTLET FLOW RATE		ENGINE POWER (kW)	MOTOR ELECTRICAL SPECIFICATIONS	DIMENSIONS			WEIGHT (kg)
			50 BAR (L / MIN)	700 BAR (L / MIN)			A (mm)	B (mm)	C (mm)	
BDD-5	700	5	4.00	0.36	0.75	400V-3ph-50/60Hz	330	230	500	21

## Assembly of hydraulic circuits

### Fittings



Ref.	Pressure (bar)	Threads		Type	Weight (kg)
A-5583	700	H 3/8" NPT x 6		5-outlet distributor	1.0
A-5508	700	H 3/8" NPT x 3		2-outlet distributor	0.5
A-5574	1500	H G1/4" x 3		2-outlet distributor	0.5
A-5511	700	M 3/8" NPT	M 3/8" NPT	M-M coupling	0.1
A-5512	700	H 3/8" NPT	H 3/8" NPT	F-F coupling	0.1
A-5513	700	M 3/8" NPT	H 3/8" NPT	M-F coupling	0.2
A-5589	700	H 3/8" NPT	M G1/4"	F-M reduction coupling	0.1
A-5590	700	H 3/8" NPT	H G1/4"	F-F reduction coupling	0.1
A-5579	700	M 3/8" NPT	M G1/4"	M-M reduction coupling	0.1
A-5514	700	M 3/8" NPT	H 3/8" NPT	90 degree elbow	0.2
Y-2/1160	700	M 3/8" NPT		8mm Allen head cap	0.1
A-5591	1500	M G1/4"		18mm hex. head cap	0.1

### Pressure gauge connections

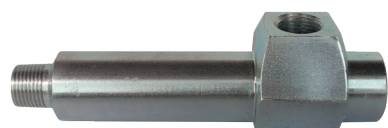

A-5501

Ref.	Pressure (bar)	Threads	Type	Weight (kg)
A-5501	700	3/8" NPT - G 3/8"	Pressure gauge connection	0.6
MGK-15/1485	700	G 3/8"	Cap	0.1

### Pressure gauges



A-5586G

A-5582G

Ref.	Pressure (bar)	Threads	Type	Weight (kg)
A-5586G	0-700 bar	G 3/8"	General use	0.4
A-5587G	0-1600 bar	1/2" NPT	General use	0.4

## Mounting accessories

### Hoses

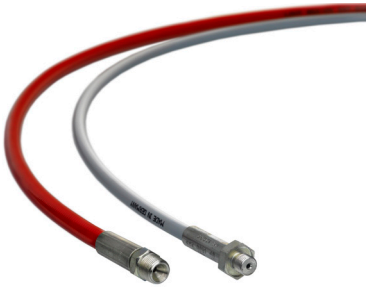

Ref.	Description	Pressure (bar)	Leng. (m)	Fittings		Weight (kg)
A-5555	1.5m hose +high-flow male connector.	700	1.5	M 3/8" NPT	A-5507-M	0.5
A-5588	1.5m hose + male quick connector.	700	1.5	M 3/8" NPT	A-5506-M	0.5
MAP-1.5	1.5 m hose	700	1.5	M 3/8" NPT	M 3/8" NPT	1.0
MAP-2	2 m hose	700	2	M 3/8" NPT	M 3/8" NPT	1.5
MAP-3	3 m hose	700	3	M 3/8" NPT	M 3/8" NPT	2
MAP-6	6 m hose	700	6	M 3/8" NPT	M 3/8" NPT	2.5

### Quick connectors

Supplied with protective caps.



Ref.	Pressure (bar)	Flow min. (l/min.)	Thread	Type	Weight (kg)
A-5506-M	700	2	H 3/8" NPT	Male	0.1
A-5506-H	700	2	M 3/8" NPT	Female	0.2
A-5507-M	700	17	H 3/8" NPT	High-flow male	0.2
A-5507-H	700	17	M 3/8" NPT	High-flow female	0.4

### Valves



Ref.	Pressure (bar)	Threads		Type	Wei. (kg)
A-5509	700	M 3/8" NPT	H 3/8" NPT	Shut-off valve	1.0
A-5510	700	M 3/8" NPT	H 3/8" NPT	Safety valve	1.0
A-5570	700	M 3/8" NPT	H 3/8" NPT	LCS valve with cushioned descent	0.2
A-5538	700	M 3/8" NPT	H 3/8" NPT	Overpressure valve	0.3
A-5690	700	M 3/8" NPT	H 3/8" NPT	Shut-off valve with 2 outlets	1.0
A-5700	700	M 3/8" NPT	H 3/8" NPT	Shut-off valve with 4 outlets	1.0







NEW MEGA XXI, S.L.

Sales Spain Tel.: 94 622 5090 - pedidos@mega.es

Sales International Tel.: +34 94 622 5090 - export@mega.es

Polígono Industrial Eitua, 6 - 48240 Berriz (Bizkaia) Spain

[www.mega.es](http://www.mega.es)